

St. Patrick Town Hall

Celebrating our next half century of faith

June 2019

St. Patrick Town Hall

- Present
- Near Term Needs
- Future

Present Facility



Present

- Community

- Growth:

- Population: Families
 - 2002- 300
 - 2019- 567
 - Demand for services increases each week

- Religious Education

- 2002: 80
 - 2019: >280

- Sacraments

- Baptisms: 2002 - 18 2018 - 19
 - First Communion: 2002 - 11 2018 - 29
 - Confirmation: 2002 - 29* 2018 - 18 * St. Patrick & St. Juliana
 - Weddings: 2003 - 2 2018 - 5

- Finances – 2003 : ~ \$200,000

2019 : \$476,000

Near Term

What's in the works

- 2 Modular buildings
 - Additional classroom / meeting space
 - Gift from Sacred Heart
 - Our cost: Move and set up



- Need another access point to and from the property
 - More parking
 - Ease of Access in and out



St. Patrick Town Hall

- Future
 - Property: 12 acres
 - Been here since 2005 – 14 years
- Master plan
 - Phase I: Multi-purpose building to accommodate short term growth
 - Worship Space
 - Class rooms
 - Offices
 - Social Hall
 - storage
 - Phase II: Dedicated Worship Space
 - Phase III: Classroom buildings

Master Property Plan 2002

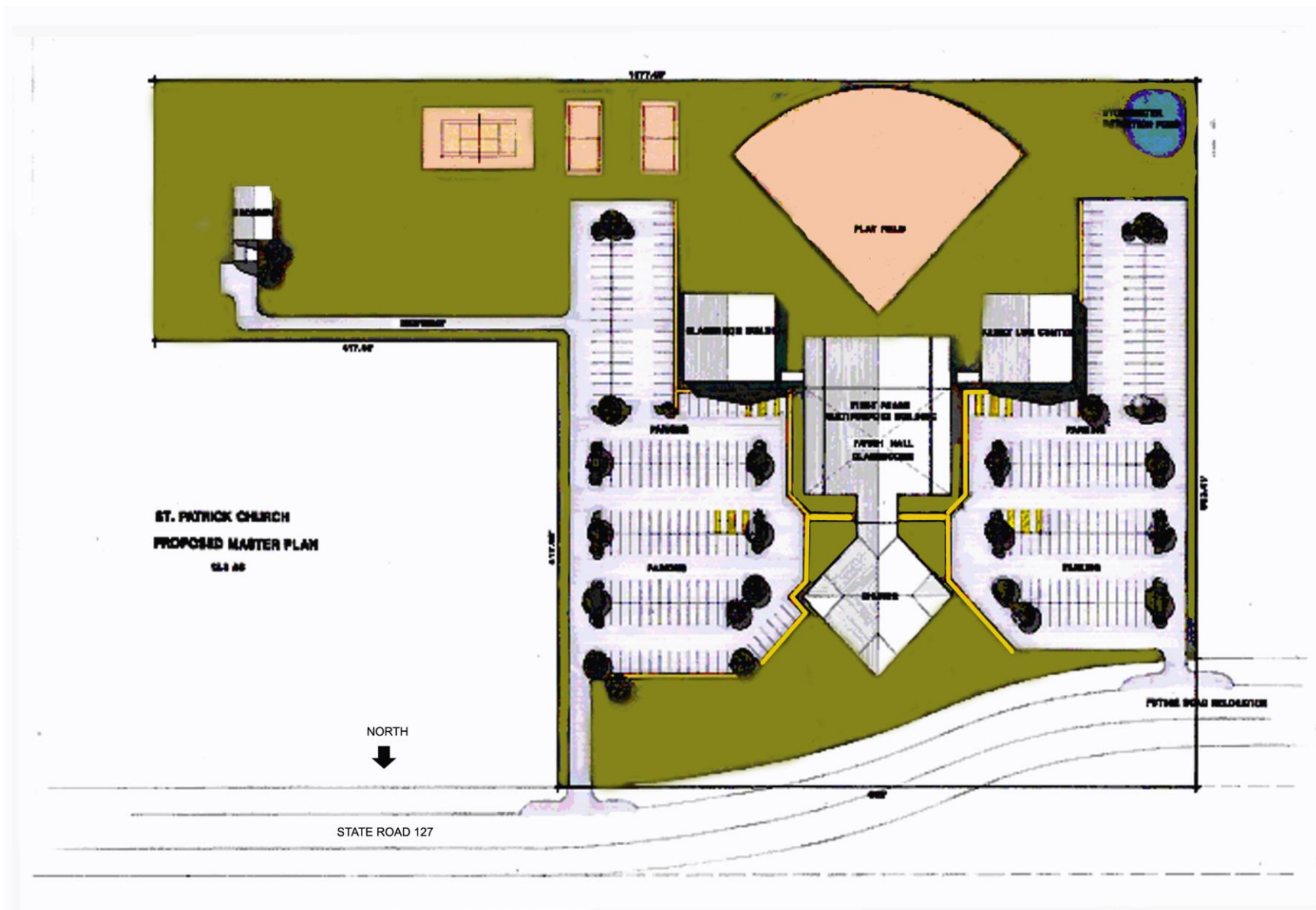

What am I getting for my pledge? 2002

- **14,000+ Square foot multipurpose building**

- ...Seating for 400+
- ...Classrooms
- ...Nursery
- ...Pastor's Office
- ...Secretary's Office
- ...Kitchen
- ...Chapel
- ...Bathroom Facilities
- ...Storage
- ...Library

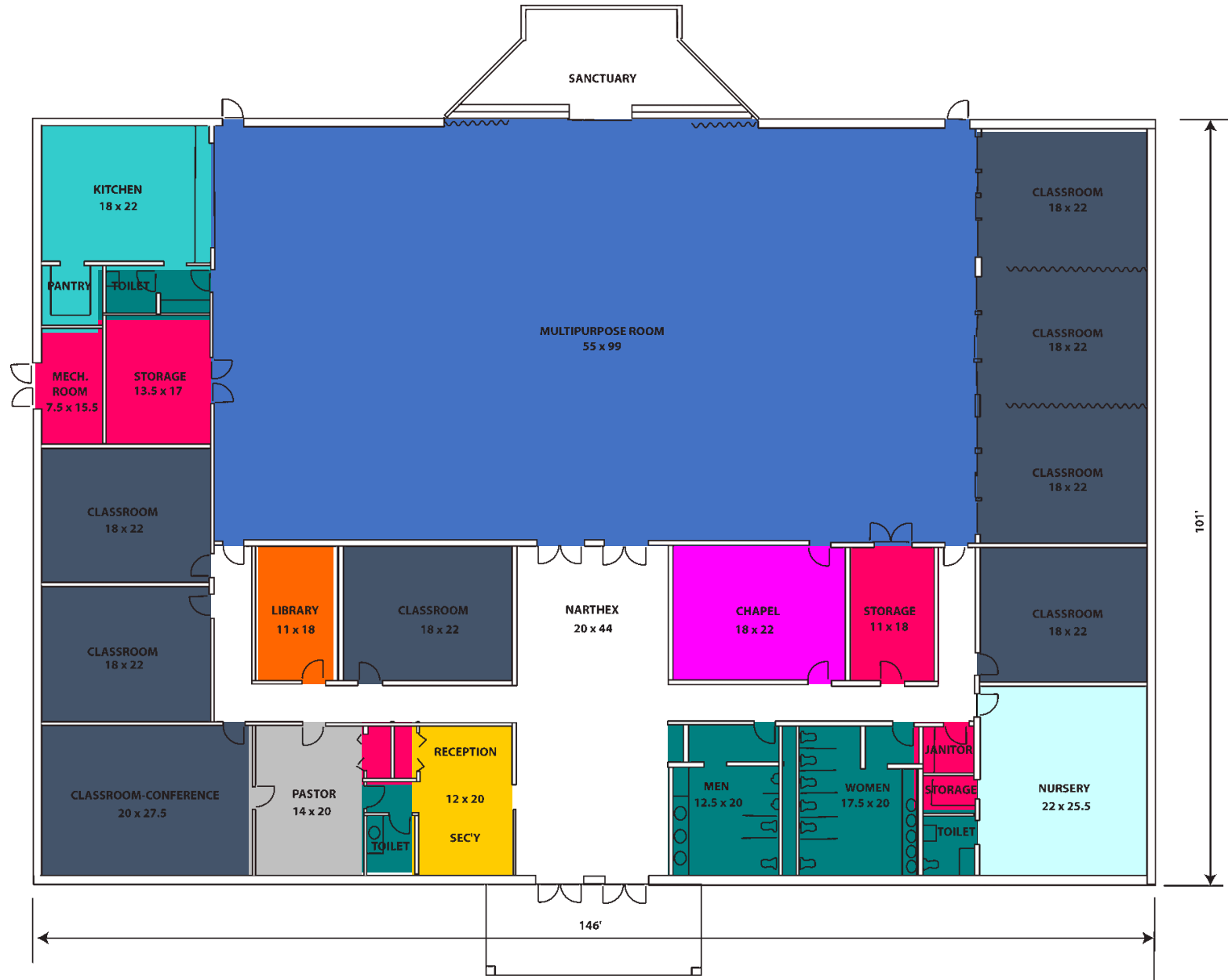

Presentation 2002: Phase 1

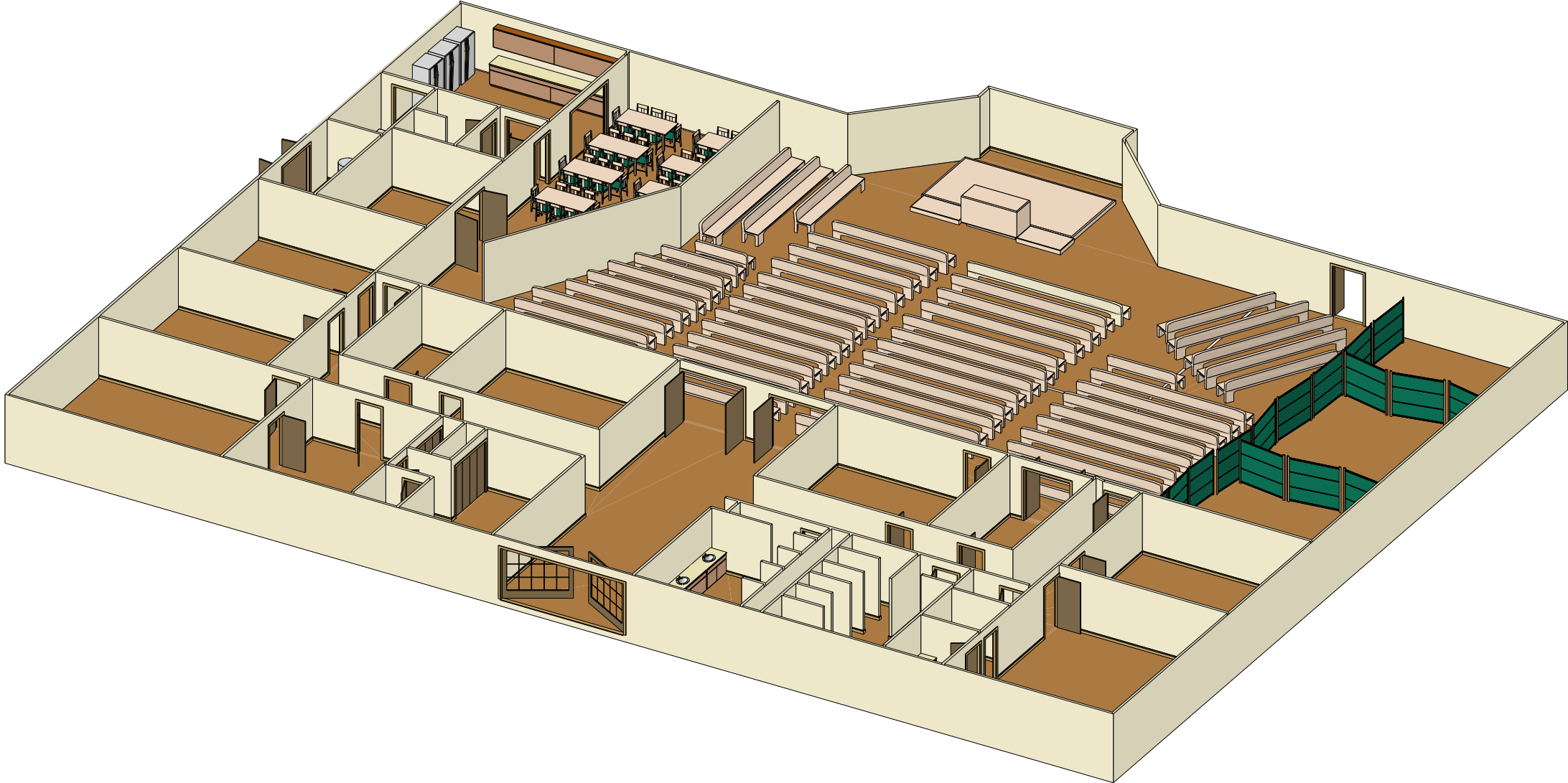

Enlarged view of Multipurpose room: 2002

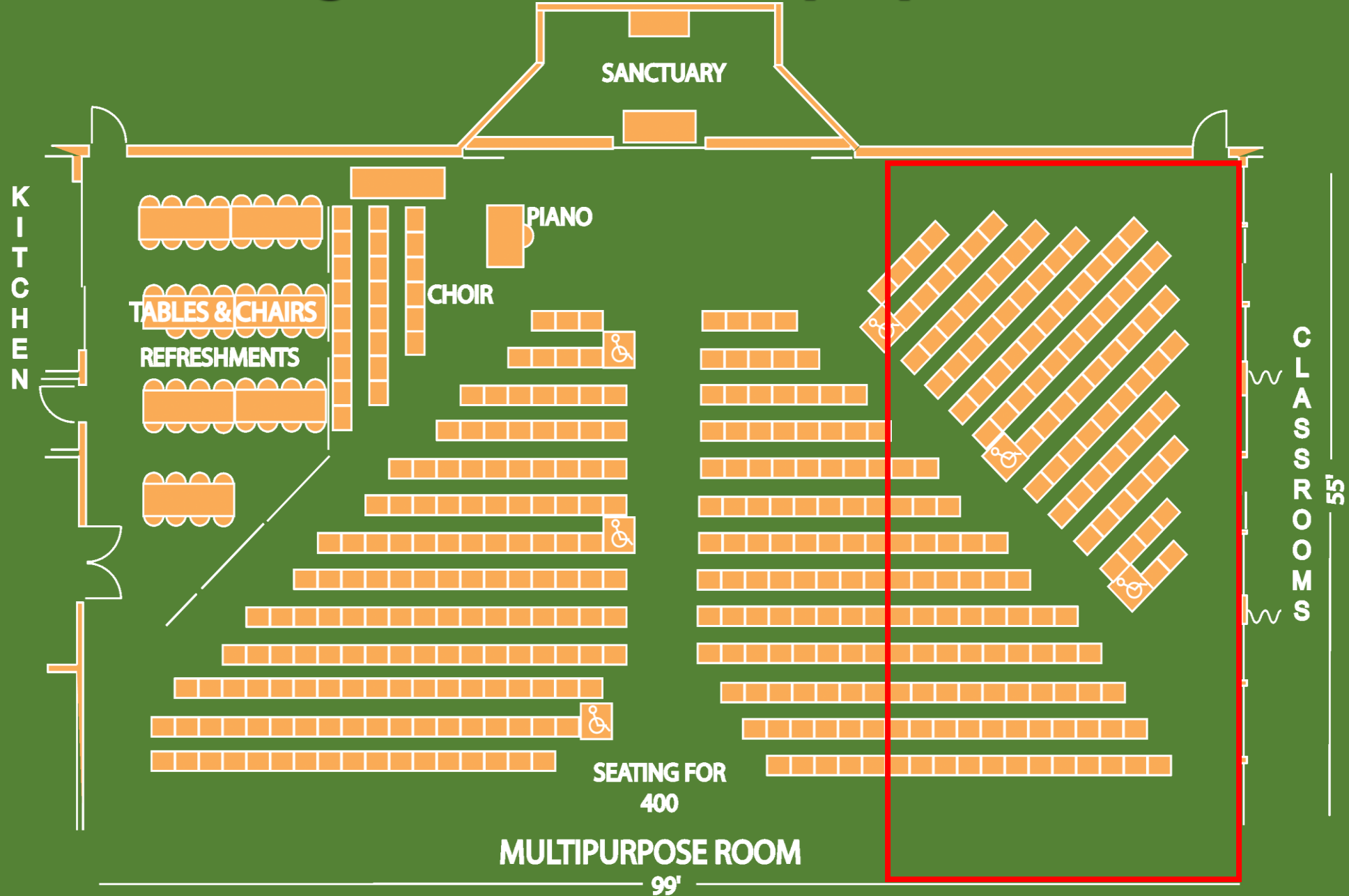

Master Plan 2004



St. Patrick Town Hall

- For 14 years our children have seen this space as
 - Class / meeting space
 - Social hall
 - Vacation bible school
 - Cafeteria
 - Rarely a place of the sacred.

What we were used to growing up

- Time For Phase II: Exclusive Worship Space?
 - Is this what we need or want?

Yes

Our Town Hall Goal

1. Let you know what we've done so far.
 - Parish Visits
2. What's next?
 - Survey – Parish Council
 - Establish Building Committee – Fr Eric
 - Meet with Diocese

Parish Council Site Visits

- Over the last 9 months, members of the parish council visited churches throughout the area
 - What would a St Patrick Worship space encompass.
 - What works best for our parish community.
- What we need
- What we looked for
- What we saw
- What we liked
- What we did not like
- What we learned
- What to consider
- What should we also consider
- What now

What we need

- A worship space for at least 600.
 - Our current setup accommodates ~ 450 counting Cry room and Chapel
 - We can seat ~ 600 using the triple classroom
 - Current Mass Sizes
 - Our Regular Sunday 10:30 service is 300 max – 400
 - Sat Eve 160 - Max 250
 - Sun Eve 136 - Max 210
 - Daily Mass 20 – 30 (Chapel holds ~ 18-20)
 - It's not about just adding another Mass
- Incorporate our Icons and our Relics
- More parking
- Be able to use our facilities for what they were originally designed.
 - Social hall, classrooms etc.
 - The triple and double class rooms are also mini social halls.
- Maybe Replace temporary structures with permanent buildings
 - Modular Buildings
 - Storage containers

What we looked for

- Spent about 1 Hour at each church
- Looking at Style not Size:
 - most churches were larger than what we expect to seat.
- Types:
 - Traditional, Cruciform, Fan Shape
- Styles:
 - Traditional
 - Modern
- Light and Lighting
- Sound / Acoustics
- Placement of Liturgical items
- Decoration: Stained Glass, Icons, Colors

Phase II: Why an Exclusive Worship space?

- It's always been the next Phase
- Our goal in 2005 was to “right size” the facility
 - What's our population growth look like?
 - This is the growing area of Houston County
 - Apartment complexes and new single family buildings are going up every day
- We are under and over utilizing facilities
 - Classrooms,
 - Social hall, due to having to share space.
 - Holy Thursday – Ecumenical Luncheon @ noon. Tear down
- Our worship/ liturgies are top notch but they can be even richer and fuller
- Bottom line:
Don't we owe it to God

What we would like to build



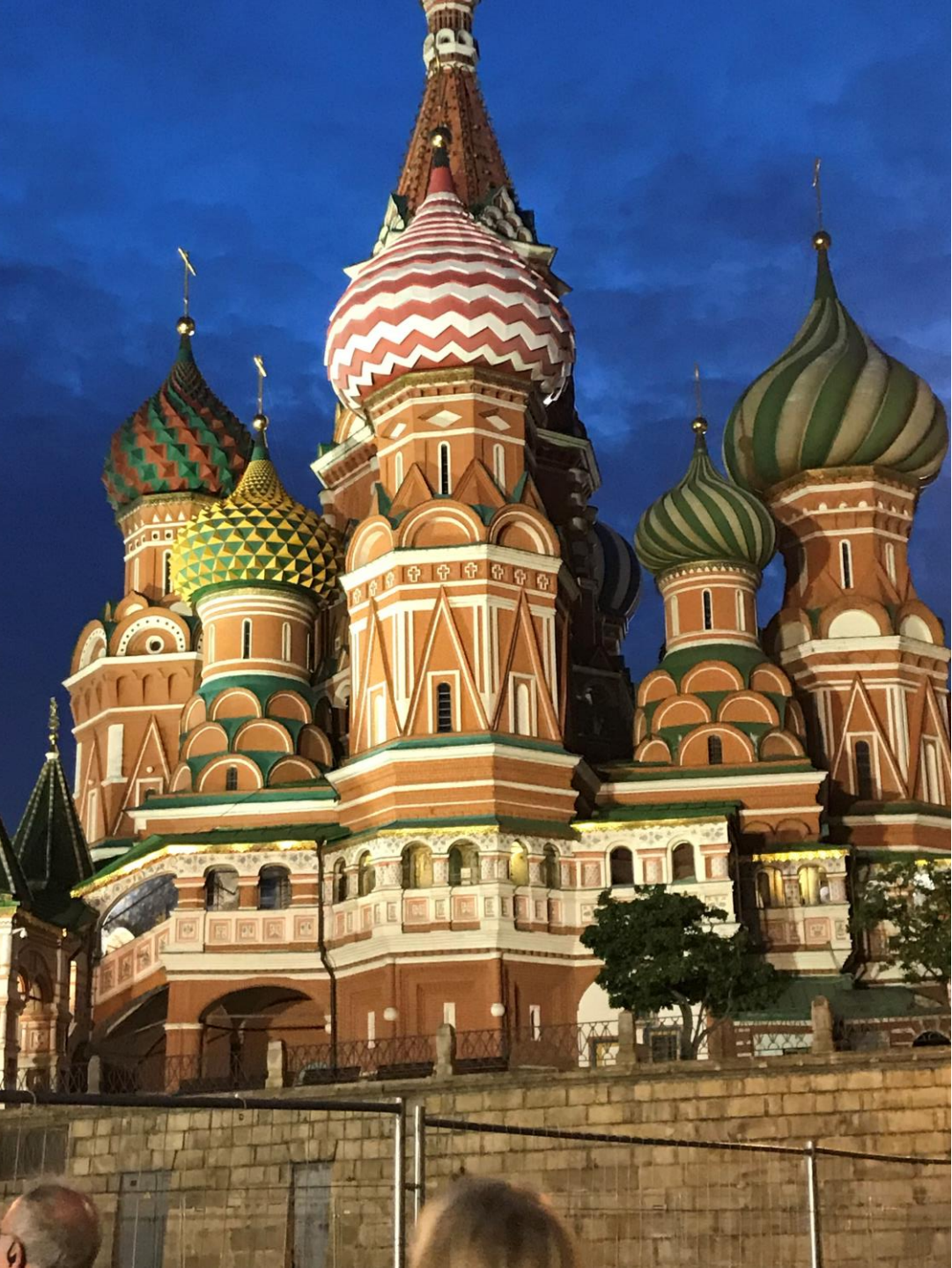



Church Types

- Traditional
- Cruciform
- Fan / In the round

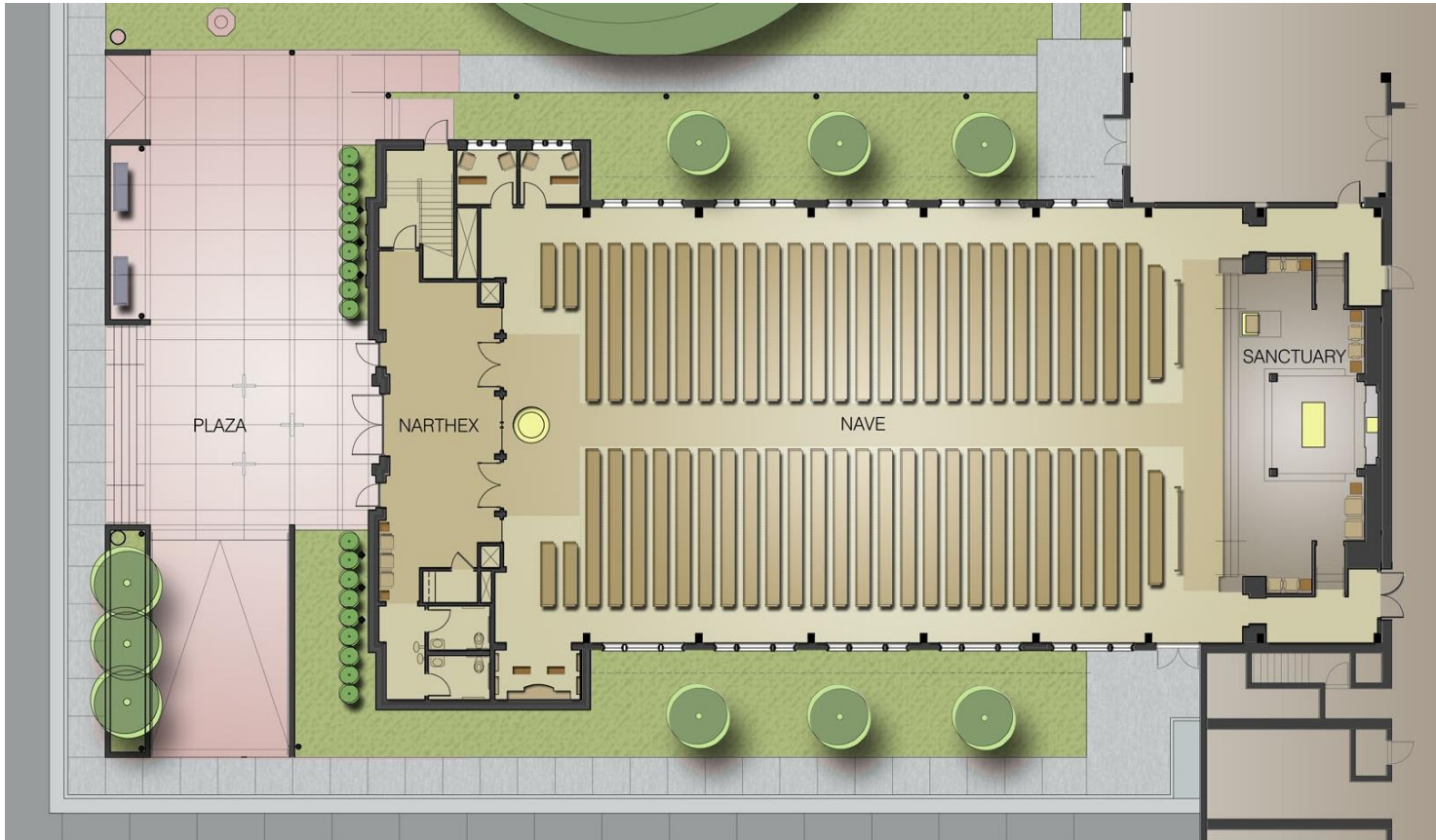

- Straight Pews
- Center / Side Aisles
- Examples
 - St. Julianna
 - St. Peter Claver
 - Base Chapel

Traditional Church Design

Cruciform

- Sanctuary / Altar in Chancel
- Side Transepts face the front / side altars
- Example: St. Joseph

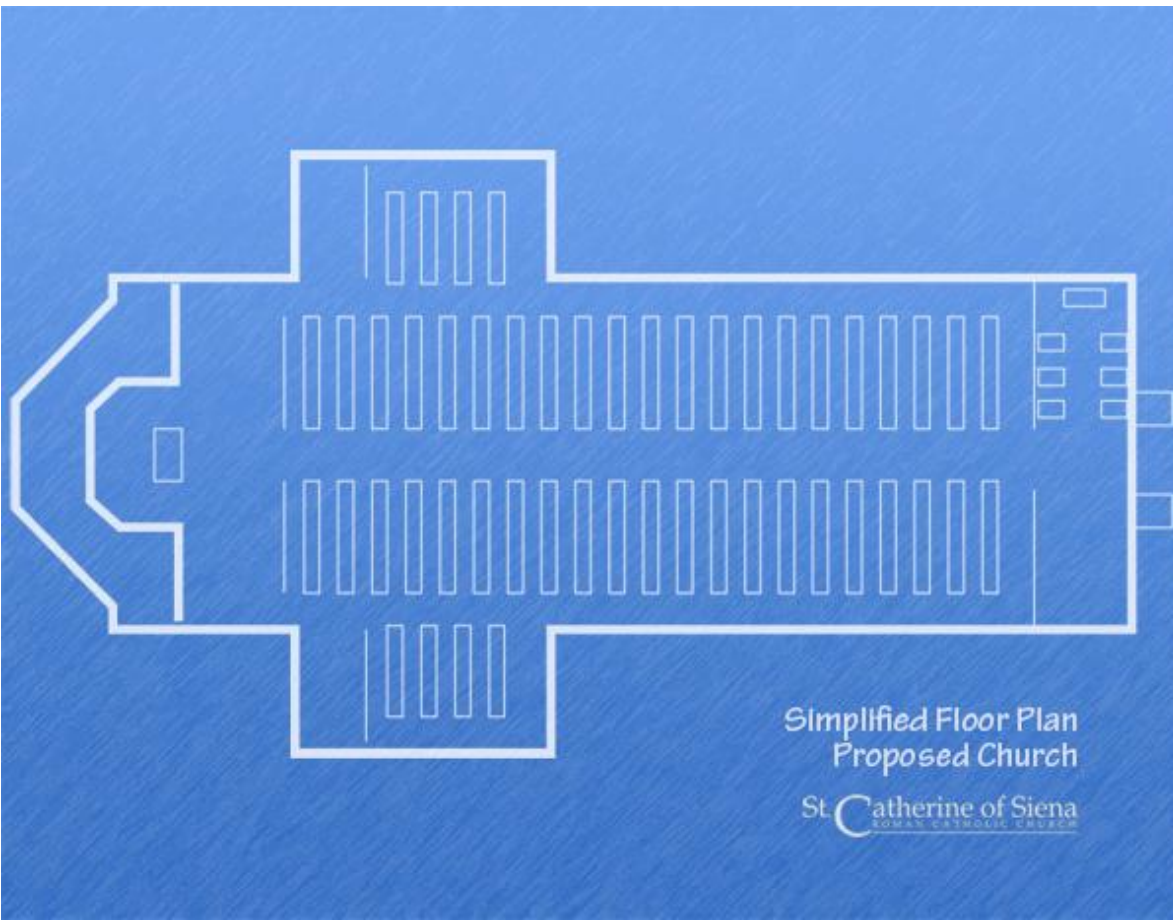

Traditional CRUCIFORM shape of church plan with ORIENTATION of Altar to the East

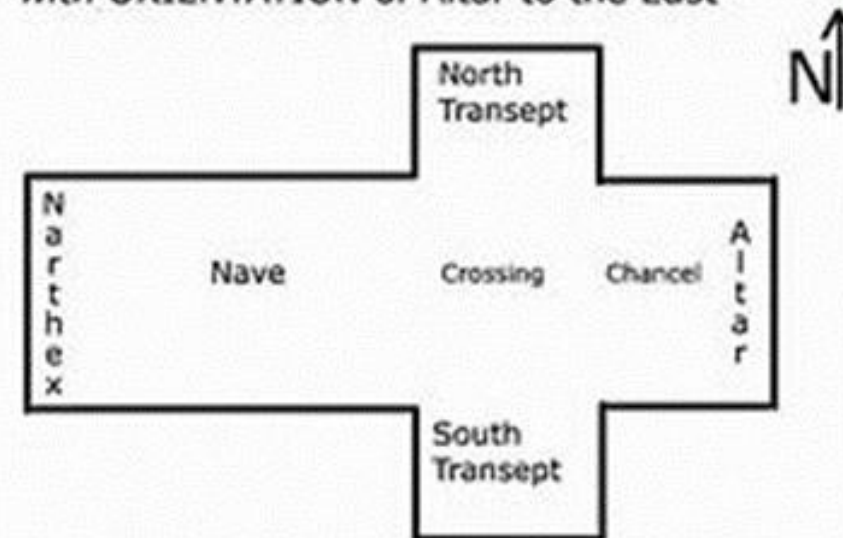

Modified Cruciform 1

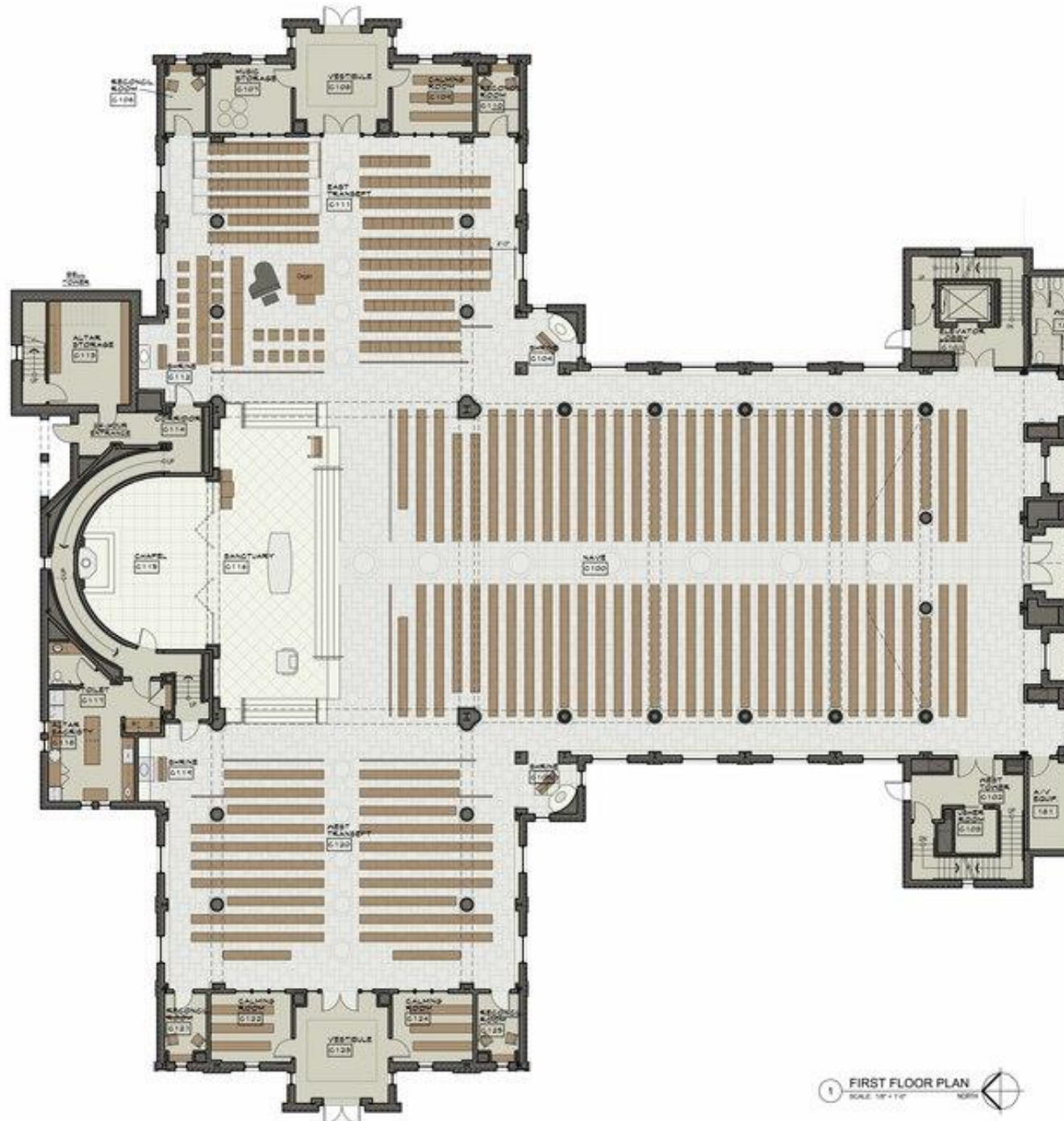

- Sanctuary / Altar moved toward crossing
- Side Trancepts face the altar

Modified Cruciform 2

- Sanctuary / Altar in Chancel
- Side Transepts face the altar

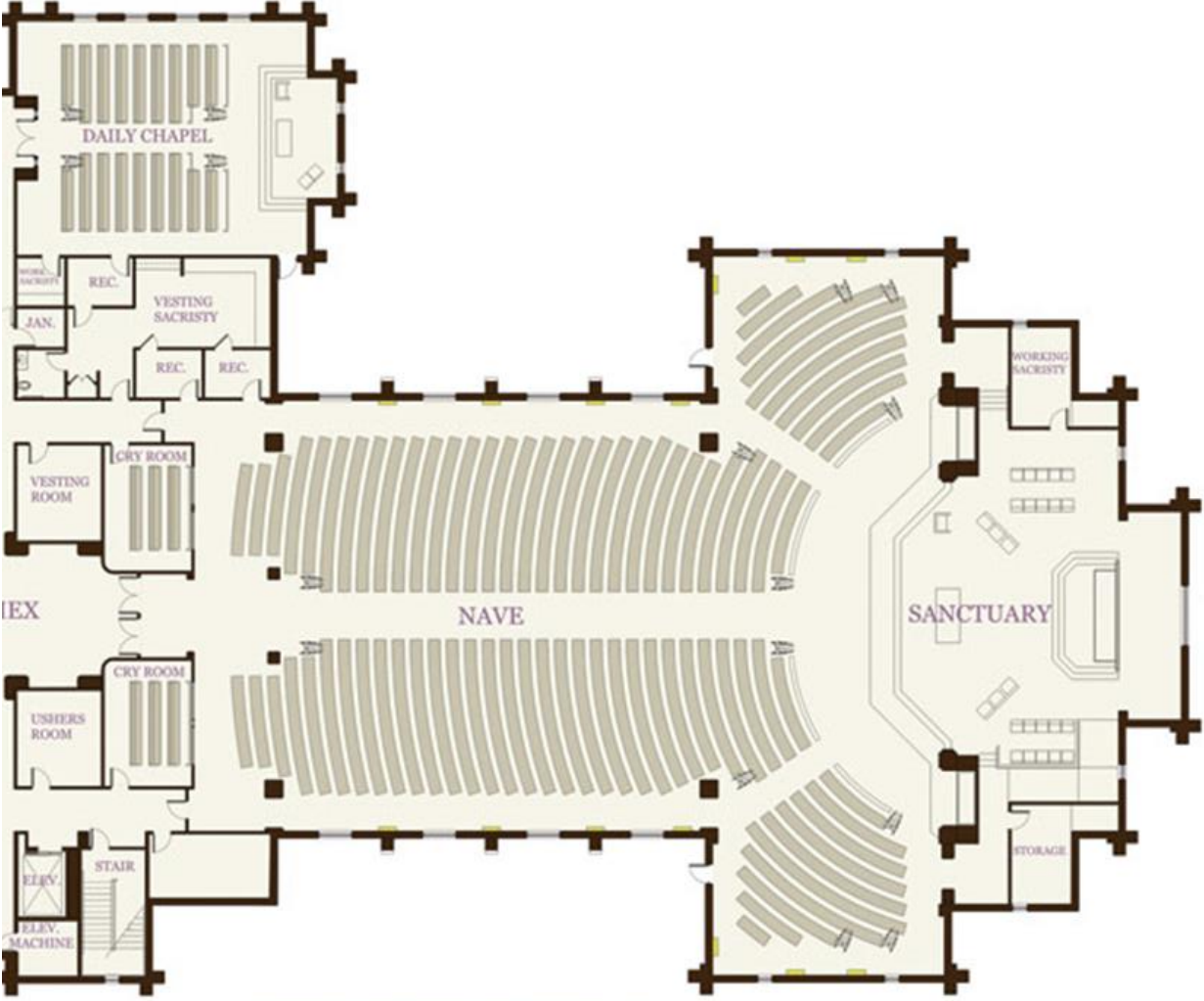

SCHEMATIC FIRST FLOOR PLAN

Modified Cruciform 3

- Greek Cross
 - Like Latin Cruciform
 - Shorter Nave

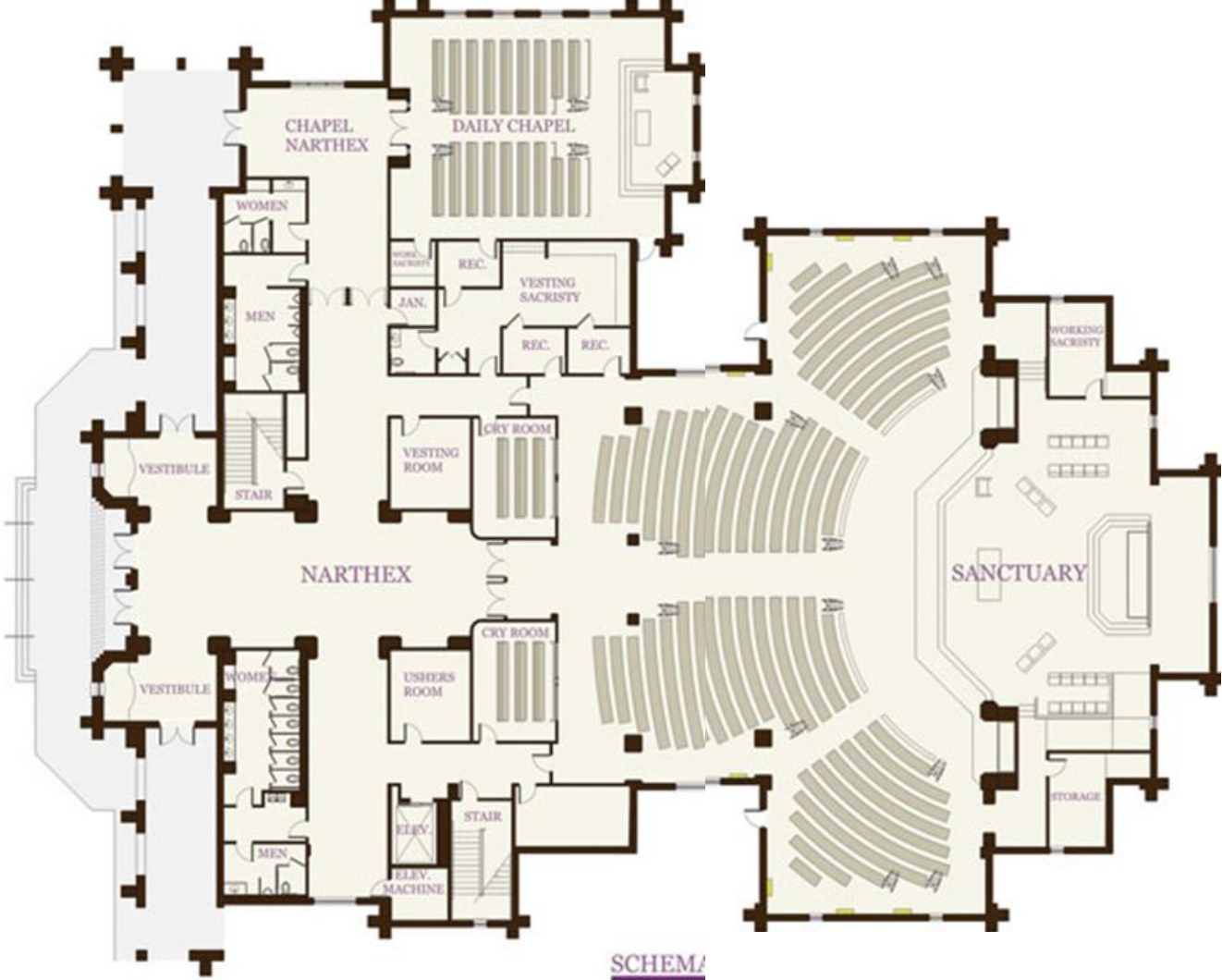

SCHEM/

Fan Shape

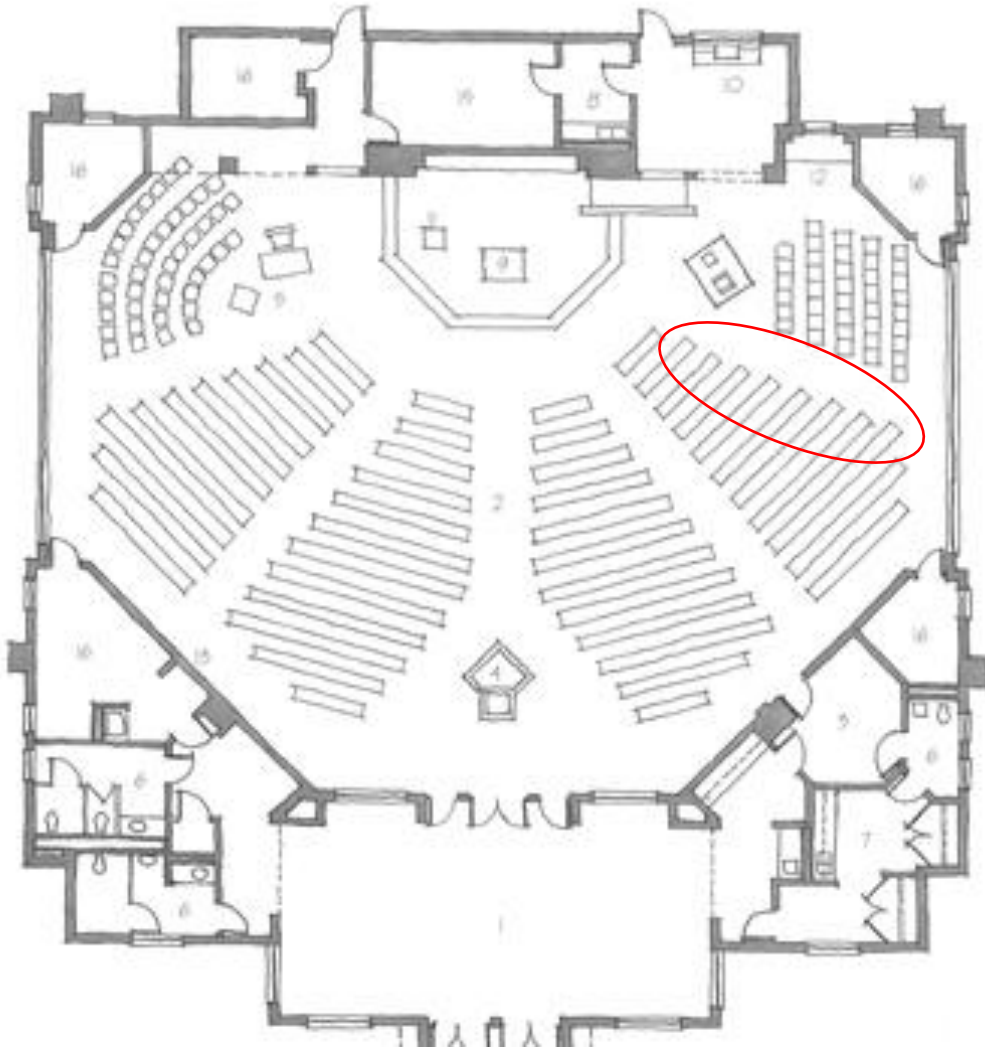

- Allows worshipers closer to altar
- Auditorium
- Many Aisles
- Angled Straight pews leave a lot of wasted space
Where do end seats worshipers kneel ?
- Examples: Sacred Heart / Immaculate Conception

Styles

- Traditional
 - Roman vs Gothic
- Modern

Roman vs Gothic

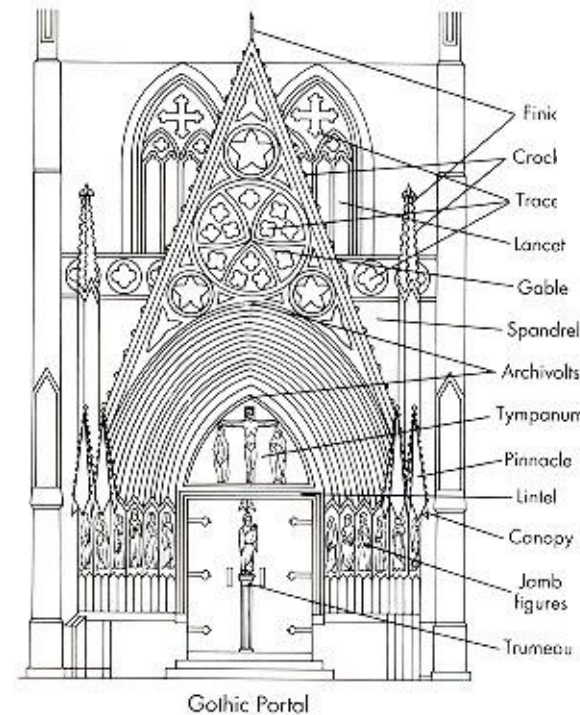
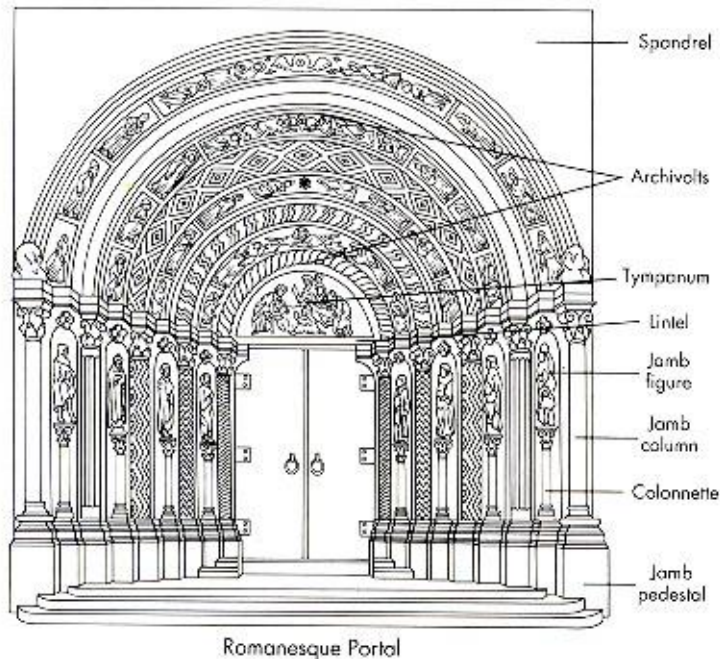
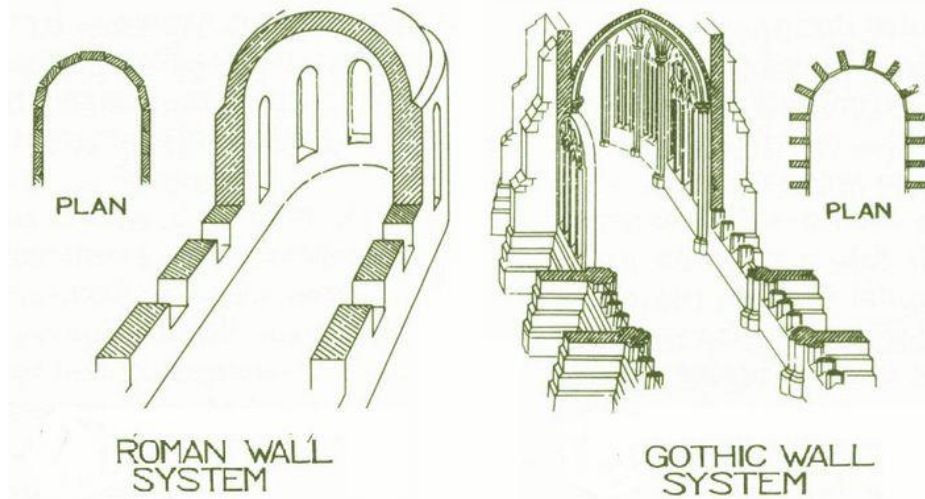

Romanesque

- The earliest churches were based on Greek temples and Roman basilicas (secular government buildings); essentially there was a substitution of a church plan for a temple plan: colonnades were shifted from the interior to the exterior; an arch was placed directly on a pier instead of placing a lintel directly on a pier (column)
- The classic temple is a system of sturdy walls and colonnades all helping to sustain a solid roof. A Romanesque church follows essentially the same principles, except that an arch is placed over the colonnades.
- All the parts of a Romanesque building contribute their share to the stability of the whole.
- The structure stands through virtue of inertia.

Gothic

- In a Gothic church the highly organized framework of piers, arches, and buttresses are organized so that the spaces of the wall and roof between them serve merely as an enclosure.
- A Gothic church is a skillfully balanced systems of thrusts and counterthrusts that are concentrated on special points of support.
- All the different levels of the church interior are brought into homogenous composition: great vaulting shafts that articulate the massive piers rise from the floor; at the clerestory level these shafts become more decorative than supportive and spring from corbels in order to trace the vaulting that articulates each bay.
- Flying buttresses allowed the walls to be dissolved.



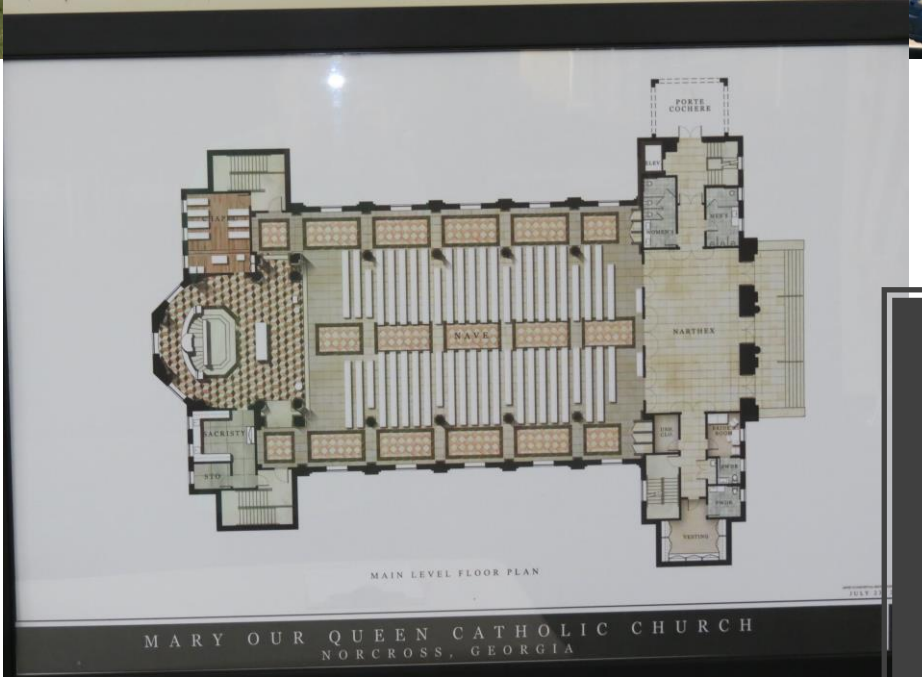

Roman



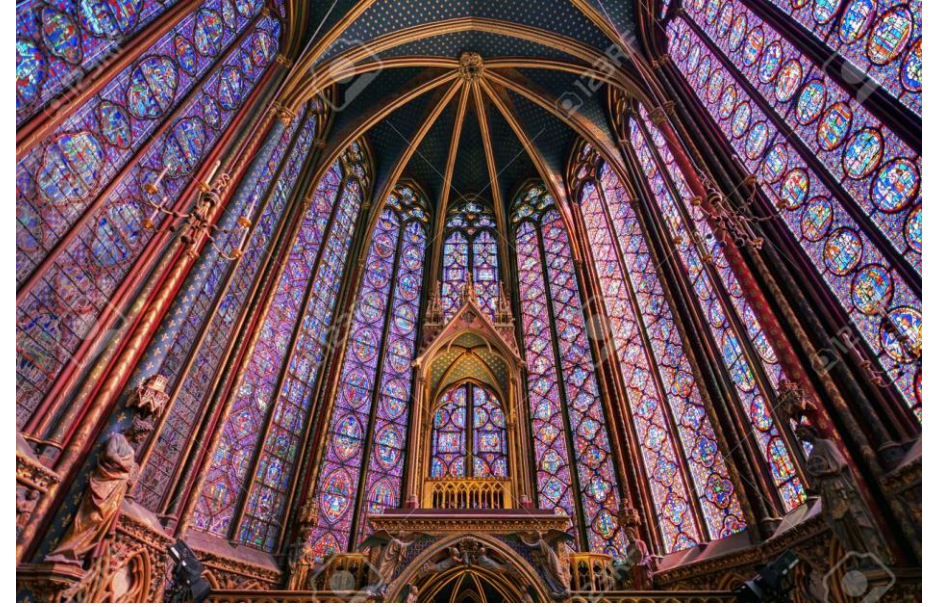

Gothic



Download from
Dreamstime.com

ID: 47375870
© Jens Tobiska | Dreamstime.com

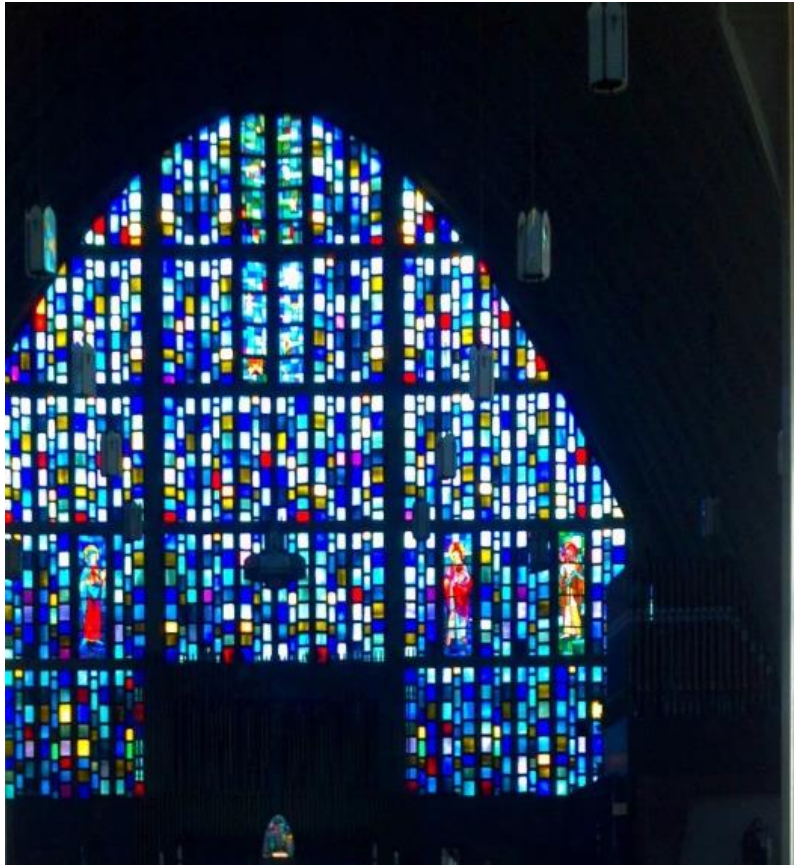

Modern Churches



Church in the Round

What we saw

- Chancery Chapel – Savannah, GA
- Sacred Heart – Savannah, GA
- St. Mary Help of Christians- Aiken, SC
- St. Michael the Archangel – Woodstock, GA
- St. Peter Chanel - Roswell, GA
- St. Peter the Apostle - Savannah, GA
- St. James – Savannah, GA
- Immaculate Conception – Dublin, GA
- St. Teresa of Avila – Grovetown, GA
- St Thomas Aquinas – Alpharetta, GA
- St. Anne – Richmond Hill, GA

- King Richard Liturgical Design

- Sacred Heart - Warner Robins, GA



St Mary Help of Christians - Akin SC



St. Michael – St. Peter Chanel

- Similar styles
- Decoration / Ornamentation
- Altar Steps >>



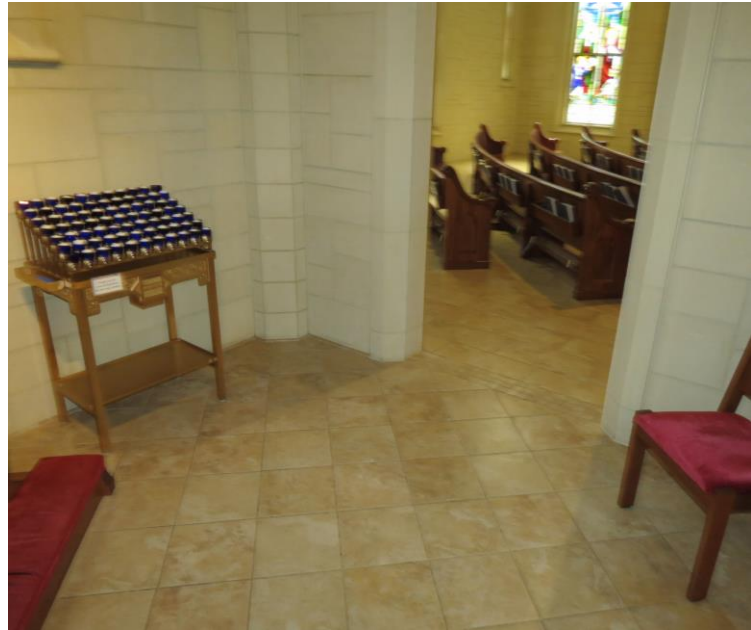
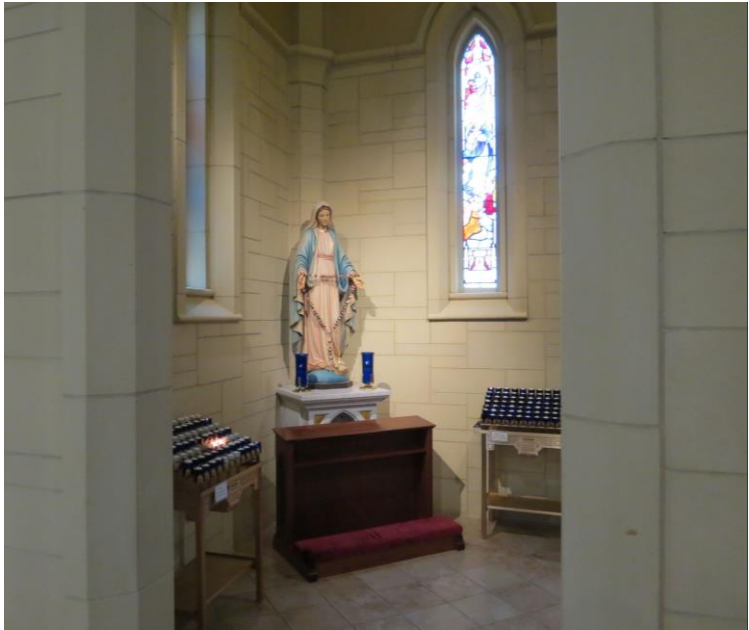

St. Peter Chancel- Niches

St James

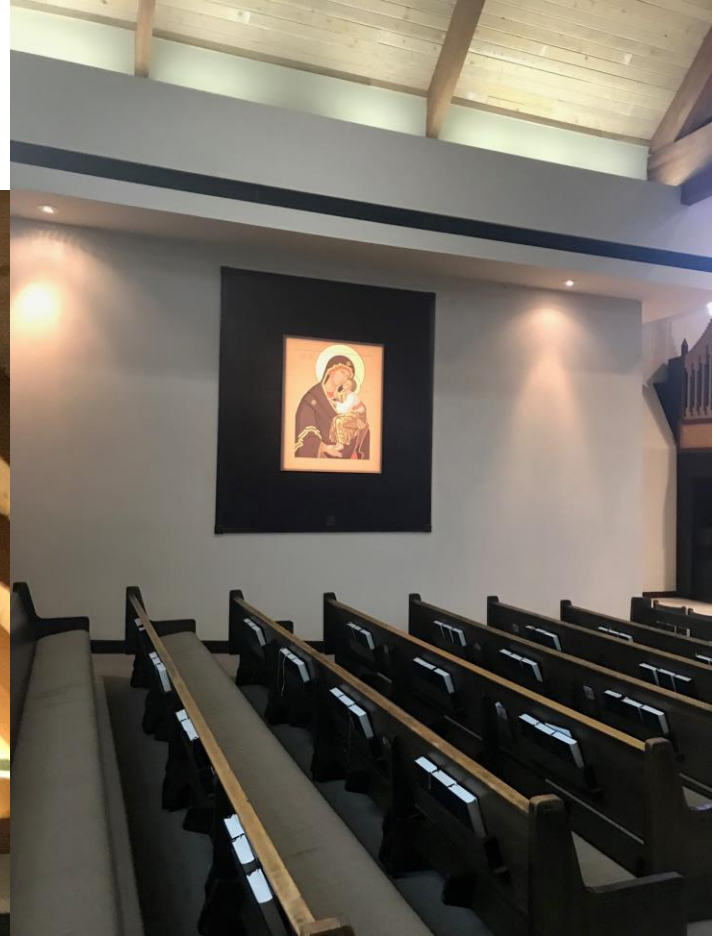

Narthex was Huge

Incorporated Icons



St James - St. Peter Savannah

- Same Fan Style
- Architectural elements make a difference
- St. Peter – lower ceiling but Stations and Gap made the roof seem high
- St James – dark band on wall made church seem low



Immaculate Conception Dublin





Immaculate Conception Dublin

St Teresa of Avila - Grovetown

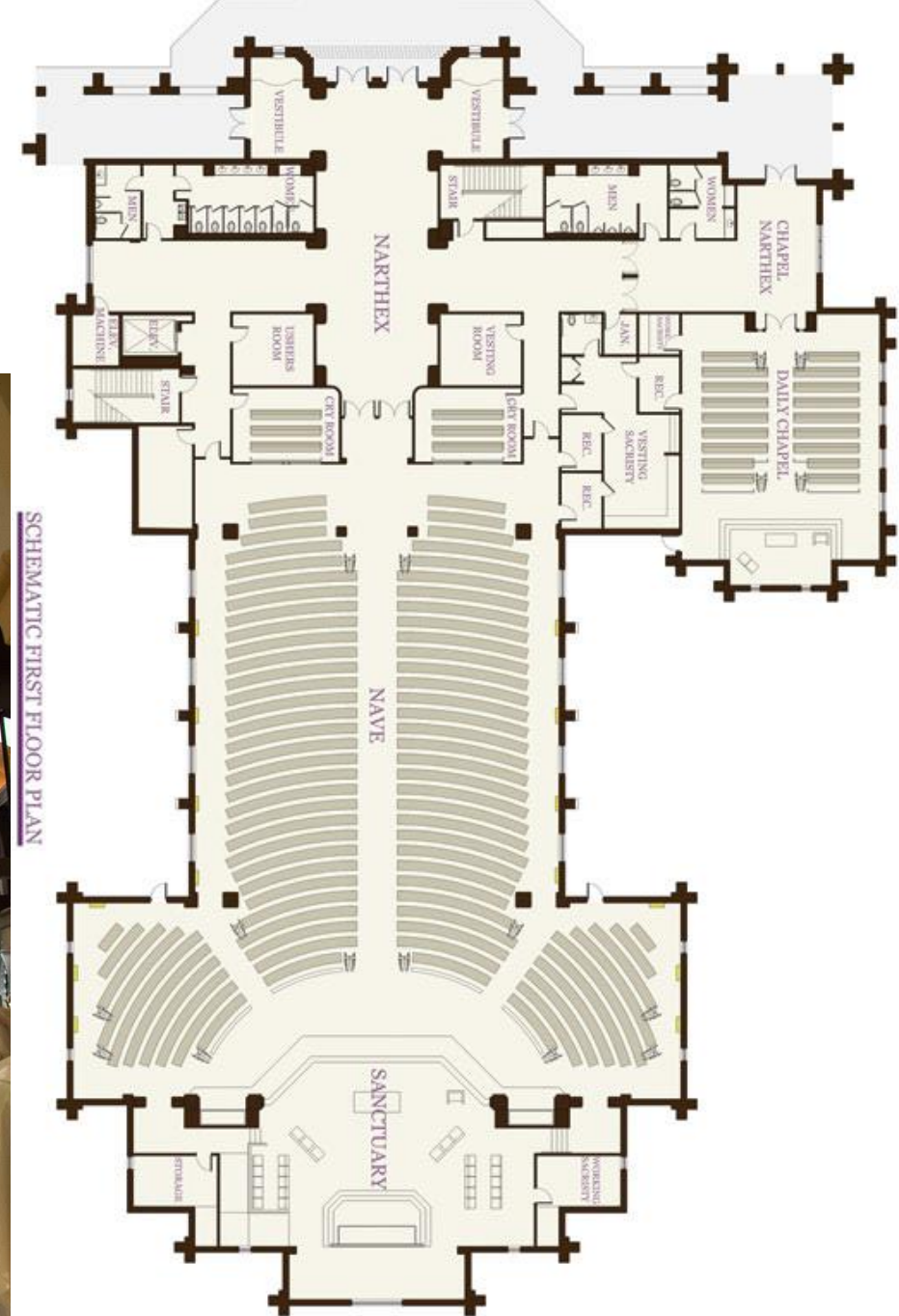



St. Teresa - Grovetown

Faux Stone



St. Teresa Day Chapel

- Seats 100
- Reused furnishing from old church (Altar/ Ambo etc.)

St Teresa of Avila





St Teresa of Avila

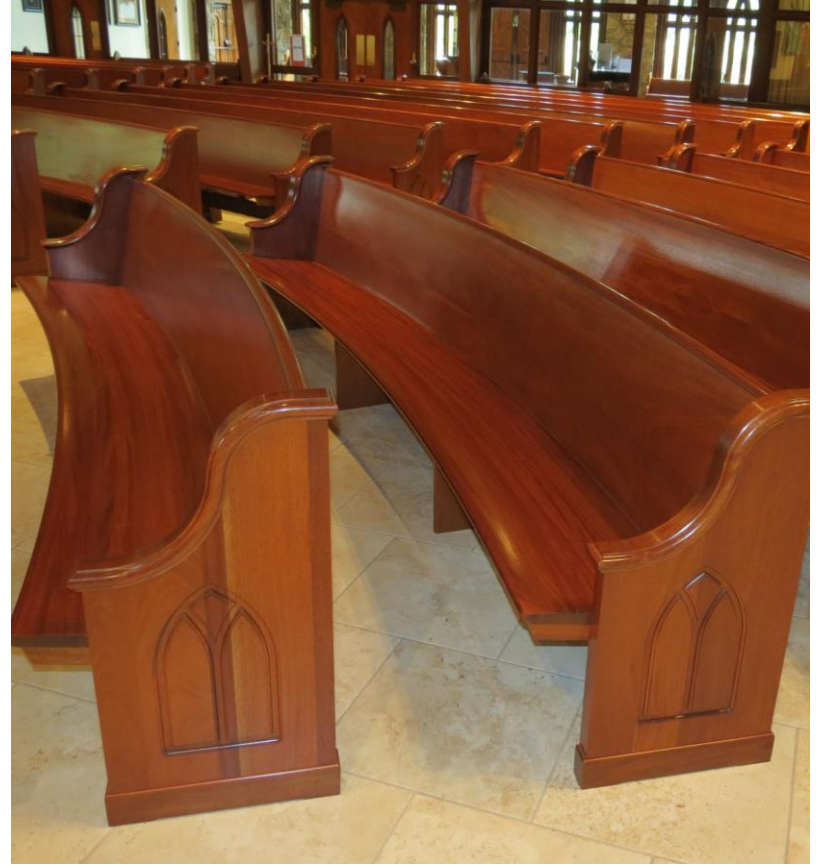

St. Thomas Aquinas Alpharetta



St. Thomas Aquinas Alpharetta

• Pros:

- Radial pews
- Sanctuary unique; the ramp built into the design. Not an after thought
- Three pane arch design carried out throughout the building
- Lots of windows
- Daily / Adoration chapel opened to main church like ours
- Felt like St Patrick
- Inviting outdoor courtyard

• Cons

- Dark wood on ceiling and all walls – very dark



St. Anne Richmond Hill

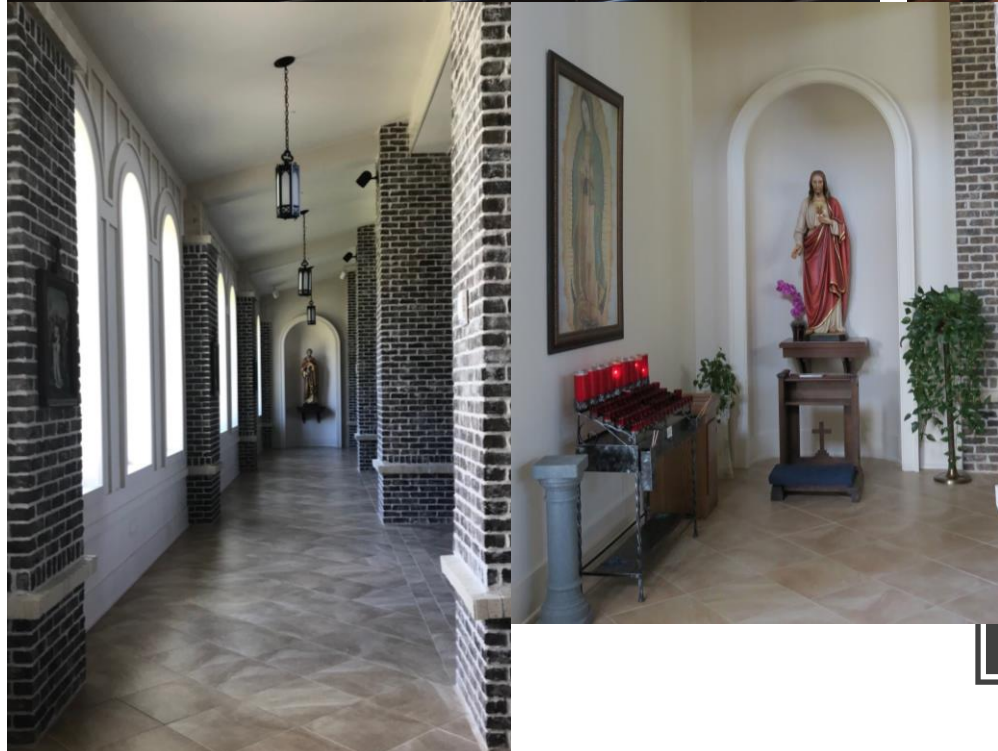
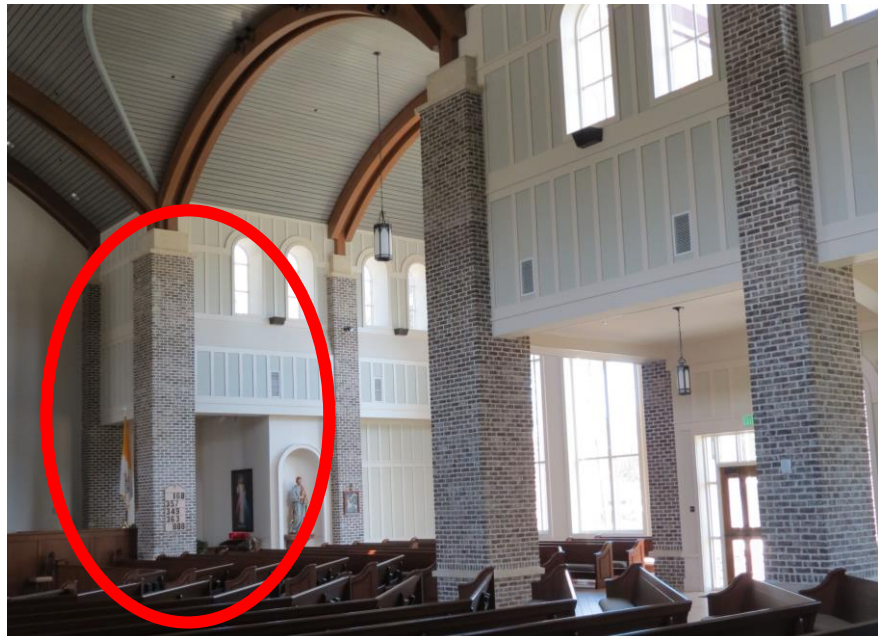

St. Anne Richmond Hill - Niches

St. Anne Richmond Hill

- Pros
 - Arched / Barrel ceiling
 - Modified Cruciform
 - Many niches for private veneration
 - Bright
 - Second story windows
 - Stained glass windows in the future
- Cons
 - Transept seating was over 180° - difficult preaching
 - Wood Back altar
 - Inadequate attempt at Radial pews
 - Side Aisle pillars
 - very large
 - Could have been arched





Arches are
already part of
who we are

ACTUAL PHOTO OF A CAR DESIGNED BY A CHURCH COMMITTEE



Fr Eric's Childhood Home – Savannah, GA



Master Property Plan 2002

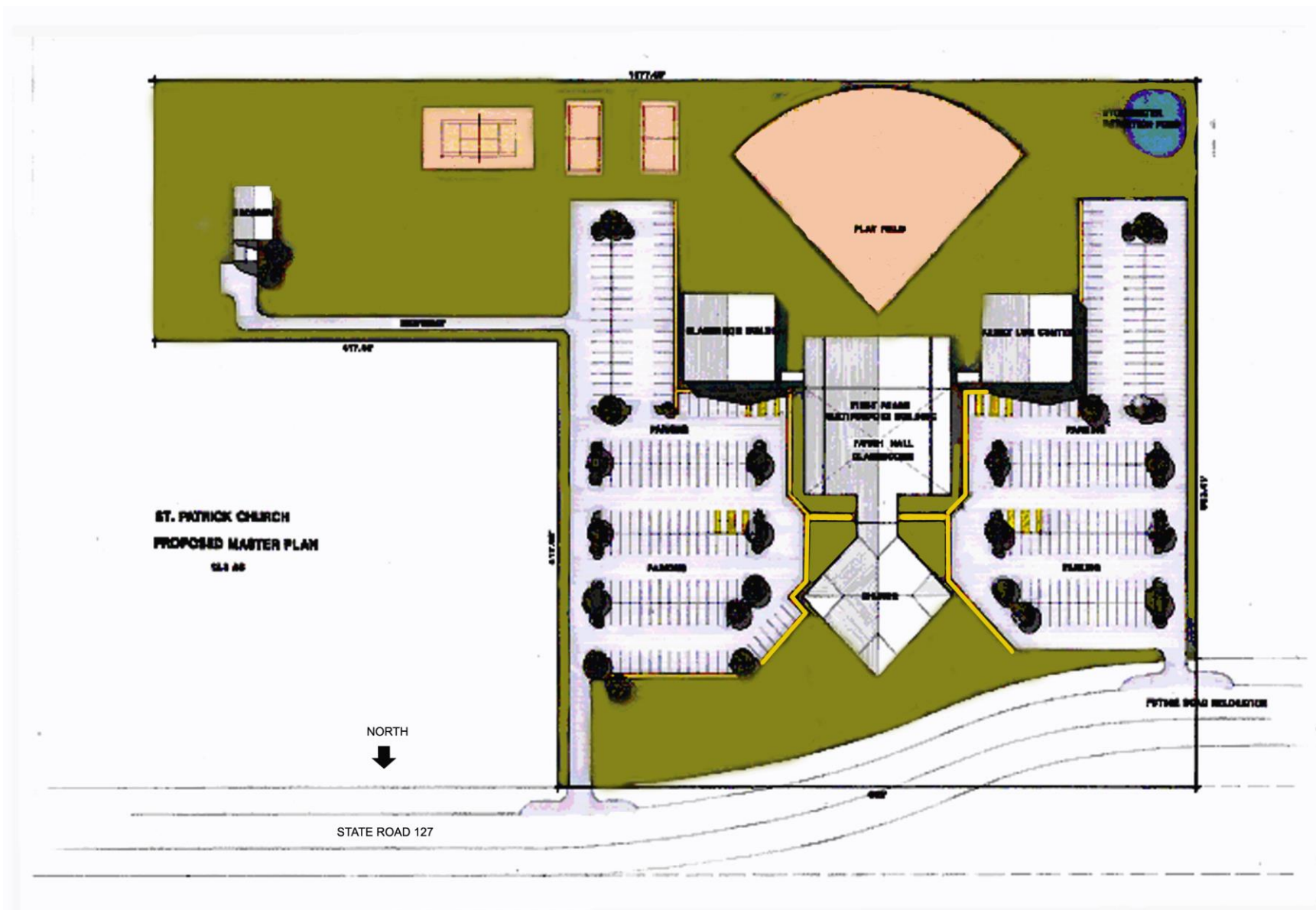

St Teresa of Avila - Grovetown

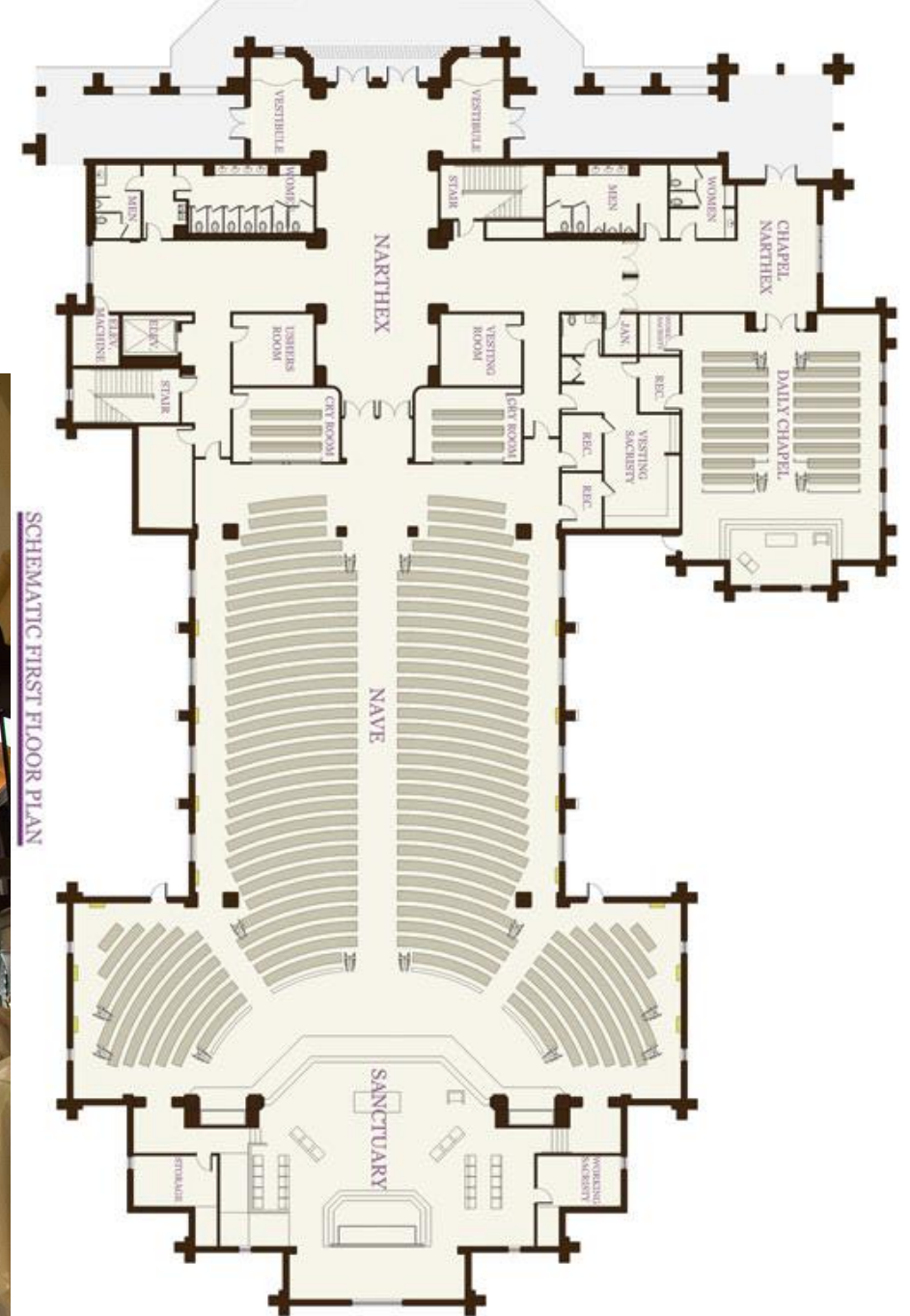

What We Liked

- Modified cruciform maybe even more like Greek cross
- Pews
 - ***** Radial Pews *****
 - Color:
 - Not dark
 - not blond maybe with celtic cross or trinity knot on side
- Arched ceiling with paint and wood - St Anne Tie in to our arches in our building
- Arch Side Aisle but smaller round pillar vs square pillar maybe faux marble like the savannah cathedral
- Stained glass surrounded by clear/translucent glass like Immaculate conception
- Focal Point Stained Glass windows: front and back walls, maybe the sides as well
- Faux stone work like St Teresa

What We Liked (cont)

- Veneration Niches for Relics / Icons
- Music up front
- Baptismal font up front – Bishop Hartmeyer desire
- Place for the Icons
- Separate Day Chapel
- Training Room
- Drive through overhang
- Large Narthex like St James
- Working back sacristy with Sacrarium
- Reconciliation rooms
- Columbarium
- Choir Room

What we did not like

- Dark interior
- Too much wood
- Angled pews like Sacred Heart
- Traditional rectangle – center aisle like St Julianna
- Optical Illusion in stairs, aisles and walls
- Price tag

What We Learned

- Hire a sound engineer
- Storage
- Small Building committee (5 or less)
- Storage
- Sanctuary Steps must be distinguishing to avoid falls
- Storage
- Keep theme design throughout (Arches, Roman, Gothic, Rectangle etc)
- Storage
- Natural light with Stained Glass
- Storage
- Landscaping enhances worship experience
- Storage

What do we need to consider going forward

- Style
- Places for our Relics
- Furnishings
- Decoration

What we should also consider

- Storage
- Day chapel / Adoration Chapel
- Updated Kitchen
- Columbarium
- Gift shop
- Bell Tower
- Nursery
- Refurbish current building for social events
 - New flooring etc.
- Permanent classrooms to replace the Irish Saint Halls

What Now

- Survey – Parish Council
 - What would you like to see
 - Nothing
 - New Church
- Establish Building Committee – Fr Eric
- Hire Feasibility team - Diocese
 - What do we really need
 - What is the best guess size
 - What can we afford to build
 - Meet with potential architects

When

- Now – Get'er done.
- ?